

**CERTIFICATE OF APPROVAL FOR
BOURBON COUNTY ROAD SUPERVISOR**

I hereby certify that the Bourbon County Road Department has inspected the site of the entrance proposed on this plat and found it to meet all current safety standards including the time/site distance standards of Section 345(A)4(1) in these Bourbon County Subdivision Regulations.

County Road Supervisor _____

Date _____

CHARLES M. JONES
HELEN B. JONES
D.B. 265, Pg. 475
P.C. C, Sh. 234

CHARLES M. JONES
HELEN B. JONES
D.B. 254, Pg. 676

CHARLES M. JONES
HELEN B. JONES
D.B. 254, Pg. 676

CHARLES M. JONES
HELEN B. JONES
D.B. 254, Pg. 676

0915509 B.C. LTD.
D.B. 284, Pg. 618

NOTES:

- Parcel 1 and Parcel 2 shown hereon are the same as Tract No. 1 and Tract No. 2 described in Deed Book 147, Page 17 less that previous exception described in Deed Book 153, Page 212.
- Parcel 2 is shown hereon based on the existing legal description and does not reflect actual field measurements made by Darnell Engineering, Inc. at the date of this survey.
- Property shown hereon is subject to any and all easements or right-of-way of record and in existence at the date of the field survey shown hereon.
- Property shown hereon is subject to those restrictions set forth by the Bourbon County Joint Planning Commission for its respective zoning classification.
- This plat shall be deemed invalid if not recorded within one (1) year of the Planning Commission Chairman's signature being affixed hereto.

PETE R. DAILEY, III
D.B. 153, Pg. 212
W.B. CC, Pg. 307

PETE R. DAILEY, III
D.B. 153, Pg. 212
P.C. C, Sh. 387

LEGEND:

- ⊙ Iron Pipe Found
- #4 Rebar, 18" long, with I.D. Cap bearing "Darnell 3553" Set in Previous Survey
- ⊙ #4 Rebar, 18" long, with I.D. Cap bearing "Witness 3553" Set this Survey
- #4 Rebar, 18" long, with I.D. Cap bearing "Darnell 3553" Set this Survey
- ⊙ Mag Nail Set in Road
- Point in Road
- ⊙ Point @ Right-of-Way
- ⊙ Railroad Spike Found
- ⊙ Address

LINETYPE LEGEND:

- Survey Boundary
- Road Centerline
- Original Tract
- Right-of-Way Easement
- Adjacent Property Line
- Entrance Driveway Centerline
- Existing Power Line
- Front Building Setback Line

0915509 B.C. LTD.
D.B. 284, Pg. 618

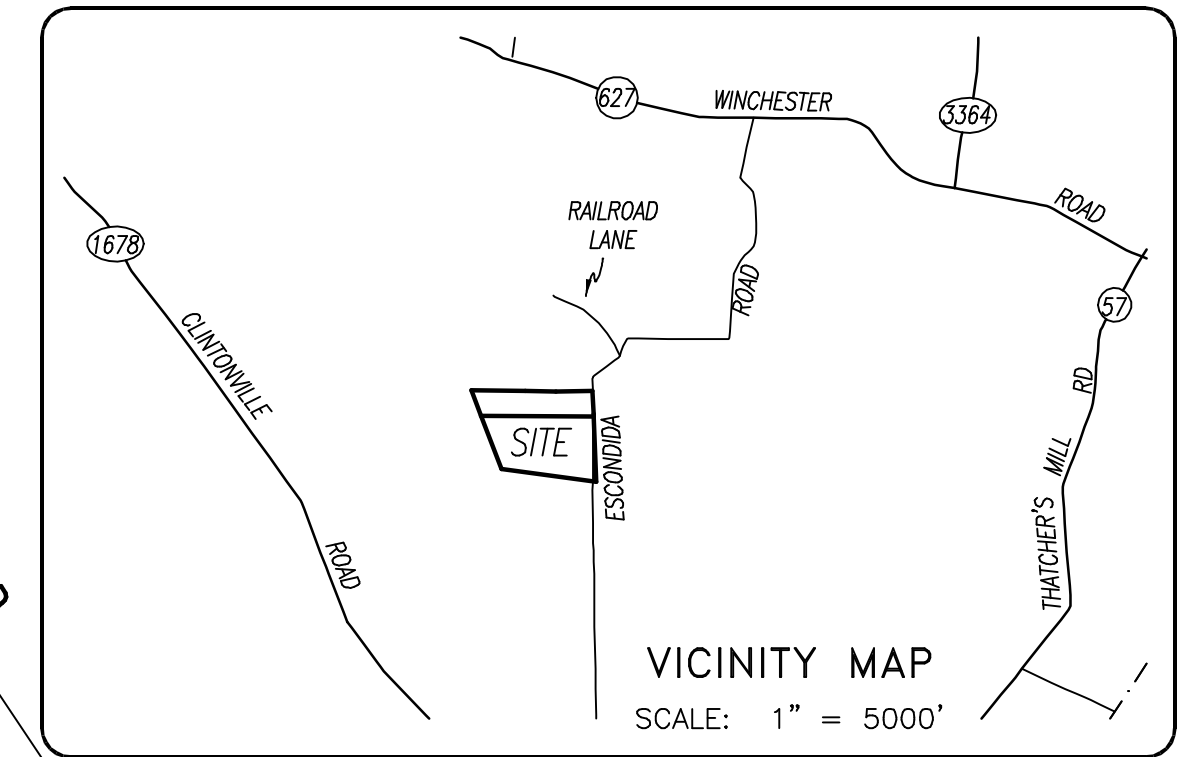

OWNER'S CERTIFICATION

I (we) do hereby certify that I am (we are) the owner(s) of record of the property platted hereon, said property being (a portion of) the same property conveyed to me (us) by _____, by deed dated _____, and recorded in Deed Book _____, page _____ in the Bourbon County Clerk's office, and do hereby adopt this as my (our) record plat for this property.

_____	Witness	_____	Owner
_____		_____	Owner
_____	Address	_____	
_____	Date	_____	Address

LAND SURVEYOR'S CERTIFICATION

I do hereby certify that this plat depicts a survey made by me or under my direction, by the method of random traverse and all monuments indicated hereon actually exist and their size, location, and material are correctly shown. The unadjusted mathematical error of closure ratio of the random traverse was $1:23,000+$ and the bearings and distances shown hereon have been adjusted for closure. The survey as shown hereon is a Class Rural survey and the accuracy and precision of said survey meets all the specifications of this class. This survey and plat meets or exceeds the minimum standards of all governing authorities. The basis of the bearings shown hereon is in relation to _____ Plat Cabinet C, Sheet 387

June 26, 2018 _____ Date _____ P.O. Box 175
Cynthiana, Kentucky 41031

COMMISSION'S CERTIFICATION

I do hereby certify that this record plat has met the requirements of the Bourbon County Joint Planning Commission, and is now approved for recording.

_____ Date _____ Planning Commission Official

SOURCES OF TITLE:

Being a portion of that property deeded John Burden & Helen Burden by Cecil Foley & Eugenia Eloise Foley by deed dated January 11, 1965 and recorded in Deed Book 147, Page 17.
See the Will of John Burden, Jr. recorded in Will Book JJ, Page 223.
See the Will of Helen M. Burden recorded in Will Book AAA, Page 509.

PLOTTED: 06/26/18 @ 8:00 BY APD

AGRICULTURAL LAND DIVISION

HELEN BURDEN ESTATE

ESCONDIDA ROAD

STATE OF KENTUCKY ALLEN PATRICK DARNELL 3553 LICENSED PROFESSIONAL LAND SURVEYOR	SCALE 1" = 300'	DATE 01/02/18	DARNELL ENGINEERING, INC. P.O. Box 175 Cynthiana, Kentucky 41031 (859) 234-8957 <small>*THIS PLAT OF SURVEY REPRESENTS A BOUNDARY SURVEY AND COMPLIES WITH 201 KAR 18:150.*</small>
	FILE NO. 17-3798	FILENAME BURDENHELEN	
	FIELD BOOK 153-47	.CRD FILE DAILEYES	
	DRAWN BY APD	CHECKED BY APD	